

PROTAGON



- **Unit pitch:** 6 cm. Pitch is maintained between luminaries.
- **Control:** DMX-512. Galvanic isolated.
- **DMX Resolution:** Normal (8bit), High (16bit).
- **Dimming Steps:** 65535 steps, for very smooth dimming.
- **DMX Channels:** User selectable from 2 channels (for all groups) up to 5 channels /per group.
- **Dimming Curves:** Linear, Logarithmic, Square.
- **Gamma correction:** Yes. From 2,5 to 1/2,5 in steps of 0,1.
- **Anti-glare:** Optional Anti-glare accessory.
- **Setup:** From external Setup Programmer.
- **Over temperature protection:** The wattage of the LED is automatically readjusted in case the temperature exceeds safety levels.
- **Ingress Protection:** IP66
- **Connectors:** Input, Output connectors for power supply and DMX signal.
- **Power Factor:** >0,98
- **Operation Ambient temperature:** -25°C / +50°C.
- **Power Supply:** 90-277VAC 50-60Hz

No. of LEDs per 60cm:

- 10x4 LEDs (4in1) for Monochromatic and Tunable White models.
- 10 multi colour LEDs (4in1) for RGBW models.



Model	Luminaire Colour	Colour Temperature & Rendering	Beam Angle	Power Consumption - Length
PROTAGON (PROTAGON)	(GR) Grey	(2780) 2700K 80CRI	(14) 14° (26) 26° (40) 40°	(110W060) 110W / 60cm
		(2790) 2700K 90CRI		(165W090) 165W / 90cm
		(3080) 3000K 80CRI		(220W120) 220W / 120cm
		(3090) 3000K 90CRI		(275W150) 275W / 150cm
		(4080) 4000K 80CRI		(330W180) 330W / 180cm
		(6570) 6500K 70CRI		(385W210) 385W / 210cm
		(WC4*) Tunable WC		(440W240) 440W / 240cm
		(RD) Red		(550W300) 550W / 300cm
		(GR) Green		
		(BL) Blue		
		(AM) Amber		
		(RGBW) RGBW		

*WC4: Tunable 2.700K-6.500K 4in1

Ordering Code Example:
PROTAGON - GR - 3080 - 14 - 385W210

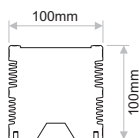
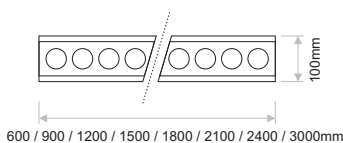



Light source Luminous Flux (lm) :

Length	60cm	90cm	120cm	150cm	180cm	210cm	240cm	300cm
Red	980	1470	1960	2450	2940	3430	3920	4900
Green	1440	2160	2880	3600	4320	5040	5760	7200
Blue	260	390	520	650	780	910	1040	1300
White	1520	2280	3040	3800	4560	5320	6080	7600
Total	4200	6300	8400	10500	12600	14700	16800	21000

1. Movable Ground Bracket

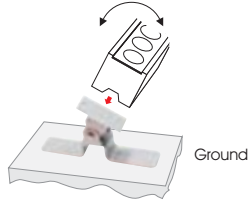

2. Fixed Ceiling or Ground Bracket

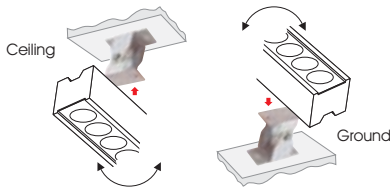

3. Fixed 10cm Wall Bracket Type A & Type B



Type A

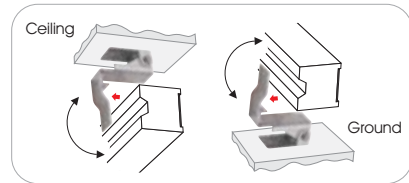
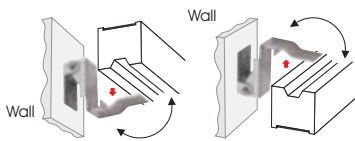

Note:
Can be used for permanent installation in ceiling or ground



Type B

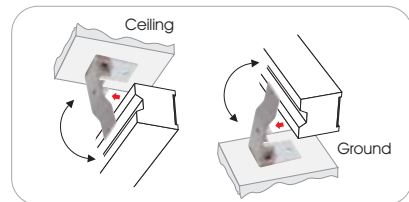
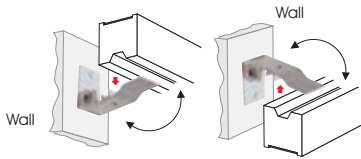

Note:
Can be used for permanent installation in ceiling or ground

4. Recessed Bracket ±5°

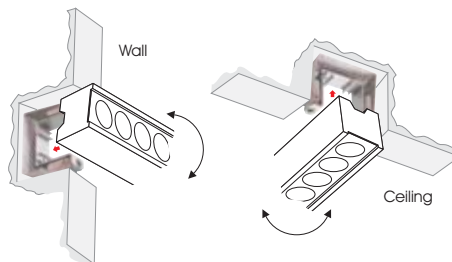

Note: Not for Inground Installation

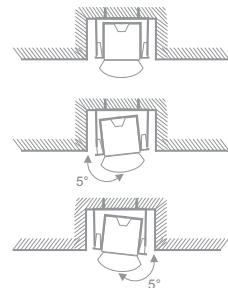

5. Fixed 20 ,35 ,50 ,75 ,100cm Wall Bracket

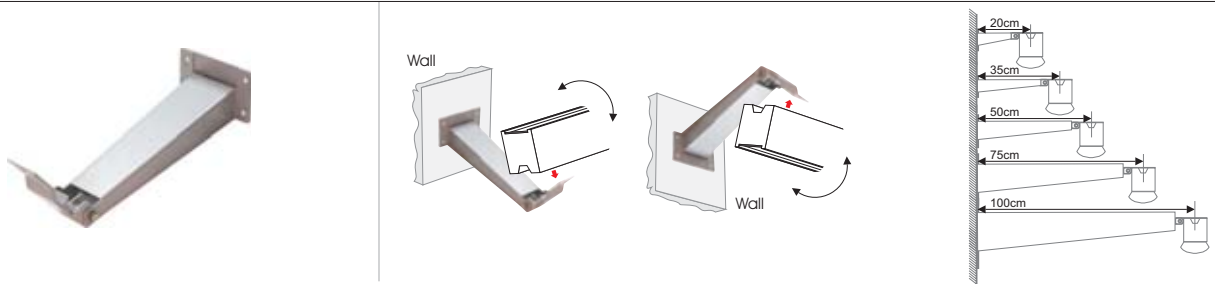

Accessories for other ways of installing 35 ,50 ,75 ,100cm Wall Bracket

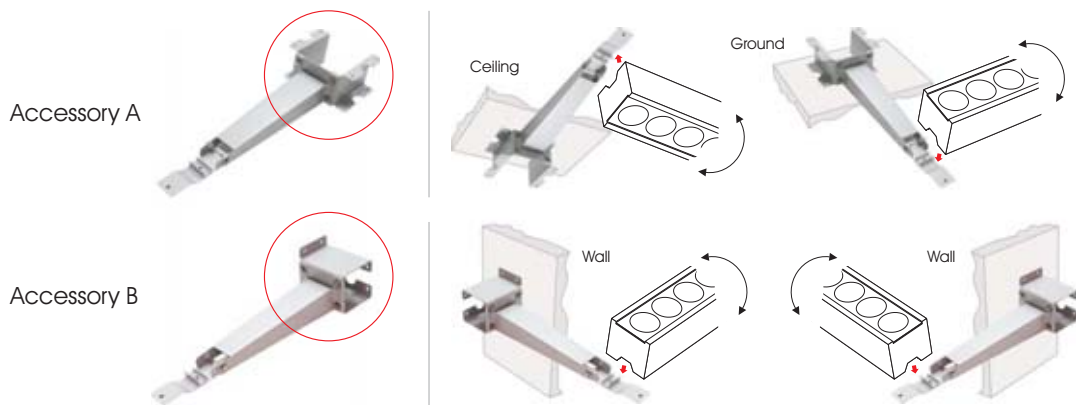

6. Adaptor for Vertical Wall Installation

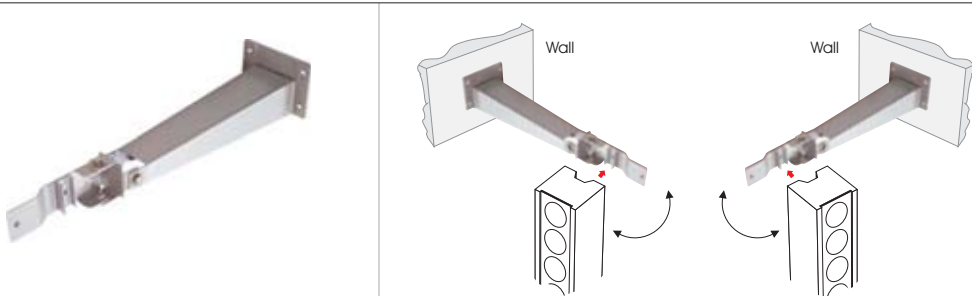

7. Slide Bracket

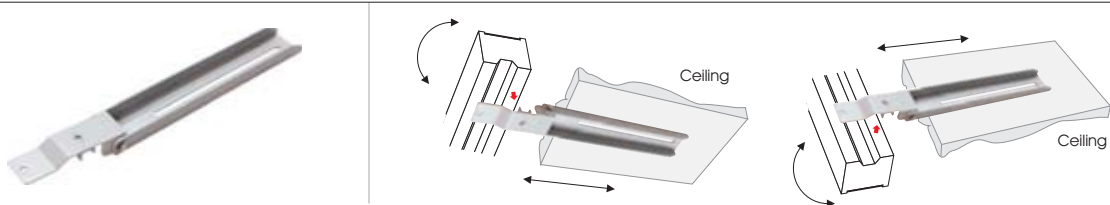

8. Antiglare Accessory

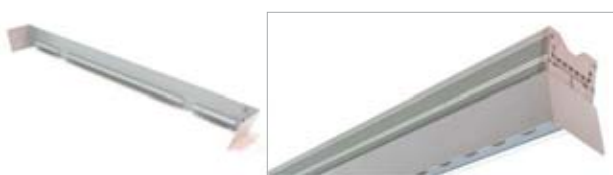

9. DMX SET UP Programmer

